



JAMES HARGEST COLLEGE HANDBOOK

Mission Statement

Our Mission is to equip all our students to create the best possible future for themselves and their world.



Vision

Tirohanga

Our vision is to foster healthy all-round development and personal success in an environment informed by the principles of manaakitanga.

This means helping young people build their personal identity and hauora in a context of strong communal values (The Hargest Way).

It involves encouraging participation, connectedness and whanaungatanga through a range of service, cultural, sporting and leadership opportunities.

Personal success is fostered by a strong academic focus and the pursuit of excellence in its broadest sense, through responsive, supportive programmes and staff working on the principles of ako.

We aspire to provide education of superb quality, in partnership with our wider community.







The Hargest Way

The James Hargest College core values are:

We respect each other

Ka manaakitia tētahi ki tētahi

We treat all people fairly

Ka mihia tika te iwi katoa

We are honest

Tino mahi pono mātou

We work hard

Tino kaha tō mātou mahi

We are responsible for all we do

Ka whakautu tūtika mātou ki ngā kaupapa katoa

We take care of our environment

Tiakina tō mātou nohonga taiao

Year 7 & 8 Programmes

Early adolescence is a time of dramatic growth physically, mentally and emotionally for young people. Learning programmes at the Junior Campus are designed to meet the needs of this age group.

Homeroom

The Junior Campus centres on a secure, supportive homeroom environment that caters for the unique social and learning needs of this age group. Students spend the majority of their day within this dedicated homeroom, where teachers get to know and care for the whole student. Most of the learning areas are delivered in homeroom including English, Inquiry Learning and Physical Education.

Specialist Subjects

During the week students have an opportunity to move out of their homeroom to our state of the art technology centre. This specialist area is set up with the interests and needs of the 10 to 13 year old age group at the forefront. Specialist teachers provide a stimulating and exciting programme created around “hands on” activities. These programmes are designed to actively involve students in learning skills and attitudes that will enhance their lives.



Enrichment – Extension

Many opportunities are provided for extension and enrichment through our GATE (Gifted and Talented) Programme. Individuals may also participate in the Science Badge and Oral Communication Programmes. Gifted athletes will be given the opportunity to enrol in the Sports Academy.

Learning Support

Students with specialist learning needs are well supported through individual education plans. Specialist support is provided in areas of Literacy and Maths, which is delivered for both individuals and in small groups.

The Whole Student

Our curriculum is designed to assist and prepare students for the transition from primary school and on to the secondary school environment. We seek to structure programmes which cater for the needs of all our students, enabling them to reach their potential. We aim to develop competent, confident self-motivated learners. Our curriculum is wide ranging and covers not only the academic fields, but physical and cultural areas as well.



Homeroom Programme

Inquiry Learning

Student learning is most effective when it is engaging, challenging and relevant to the real world. Students build skills to become lifelong learners who are prepared for their future in a readily changing world. The PRIDE model of Inquiry (Paving the way, Resource, Interpret, Display, Evaluate) is specific to the Junior Campus. It follows a process where students have ownership of their learning. They explore pathways relevant to them and expand their own ideas, values and perspectives. Students are reflective about how and what they learn. Inquiry learning is integrated into Social Sciences, English, Mathematics, Health, Digital Technology, Te Ao Māori and Drama. Links are made with whānau and the community where learning is often celebrated and shared.

English

Our students engage with and learn to enjoy language in all forms. They learn to become effective communicators, expressing themselves clearly and confidently, whilst also learning good listening habits. We aim to develop keen readers with sound understanding and research skills, and writers who can write interesting content to appeal to a chosen audience.

Mathematics

Students learn to develop skills, knowledge and confidence in number, algebra, statistics, geometry and measurement. The focus is on learning to apply mathematical ideas and processes across the curriculum and to everyday situations.

Social Sciences

Students learn about belonging and participating in society through a process of inquiry. This involves learning how societies function and looking at how to be critical, active and responsible citizens through contexts relevant to our students' lives and interests. Students have multiple opportunities to explore their learning, present their ideas in a variety of ways and participate in social action related events.



E-learning

Digital Technologies are embedded across all curriculum areas. Students will use a range of devices, either BYOD personal devices or school owned, to enhance their learning experience. Digital Citizenship will be fostered through deliberate teaching.

Drama

Students learn to express ideas, feelings and experiences through movement, sound and characterisation.



Health and Physical Education

Within Health and Physical Education, students develop the knowledge, skills and attitudes needed to maintain personal health and foster successful relationships with others. Teachers support students by providing a range of strategies to help them as they take increasing responsibility for their own well-being and the well-being of their communities. Students develop resilience, perseverance and a sense of personal and social responsibility.



Specialist Programmes

Science

Students develop scientific skills and attitudes through doing “hands-on” practical science activities.

Music

Students gain an understanding of the basics of music and musical instruments, explore composition on the computer and learn to play the keyboard.

Hard Materials Design

Students develop the skills necessary to design and create projects using workshop tools.

Foods and Textile Technology

Students gain an understanding of nutrition and hygiene and learn basic cooking skills. Learners develop and use techniques to design and make items using textiles.

Art

A range of artistic styles are explored through drawing, printmaking and painting. Students also use a variety of mediums including clay to create three dimensional art.

Languages

Different societies (French, Spanish, Japanese and Te Reo Māori) are all explored through language and culture.



Learning beyond the classroom - Year 7 & 8

- **Choir:** the choir performs within the school and the wider community.
- **School Production:** our annual production provides an excellent opportunity for singers, actors and dancers to display their talents on stage. Students also help backstage and with the technical side of productions.
- **Kapa Haka:** our rōpū learn a range of waiata and haka to perform at school, in the community and at Polyfest and Ngā Pūtangitangi. They also lead any Mihi Whakatau and have strong relationships with Senior campus Kapa Haka and Whanau Class.
- **Extra curricular sports:** the college enters teams in local competitions including netball, futsal, touch rugby, triathlon, indoor bowls, golf, cycling, softball, cricket, volleyball, basketball, rugby, hockey, table tennis, badminton, gymnastics, aerobics, underwater hockey, waterpolo, orienteering and squash.



- **Interschool sports exchanges:** we participate in an annual sports exchange with Oamaru Intermediate and participating in the CAIMS Tournament in Christchurch.
- **Interclass sports competitions:** classes compete against each other in our lunchtime interclass competition in sports such as netball, dodgeball, volleyball and tug-of-war.
- **ShowQuest:** this is a dance based performance that tells a story or conveys a message and is an excellent opportunity for students to get involved with others, be creative and work as a team. The end performance is showcased on stage and is judged under various categories. It is a fun experience for all those involved.





- **Outdoor Pursuits:** Ski trips are organised by the school.
- **International Exchange-Citizens of the World:** Our Year 8 students have a unique opportunity to represent the College, Southland and New Zealand by being selected for the Citizens of the World International Exchange with Meeker Middle School of Tacoma, USA. We host American visitors early in the year and our selected “ambassadors” travel to Tacoma in September-October (currently on hold).
- **Kids Lit:** Students compete in this national literacy competition.
- **Camps:** All students are involved in camps at the beginning of the school year which include a wide range of outdoor activities. Year 8 go to Deep Cove and Year 7 to Omaui.
- **Sport and Recreation:** All students participate in activities on Friday afternoons. Terms 1 and 4 include interclass and house competitions. Terms 2 and 3 students choose from a wide range of sports and recreation at both school and out of school venues.
- **E.I.S. Challenge:** Year 7 students work in teams to complete a series of challenges.



Frequently asked questions - Year 7 & 8

- ***Do you stream classes?***
Homeroom classes are mixed ability. In Mathematics students are grouped according to their individual needs.
- ***Is there any extra help for students in reading?***
Yes. We have the LEAP programme and specialist reading teachers take students for one-on-one reading.
- ***I want my child to get better at Maths. Is there any help available?***
Students are catered for according to their individual needs. Students with higher needs are in smaller Maths classes. Before School Maths, held two mornings a week, is an individualised programme which caters for extension as well as support.
- ***At my child's primary school, we used to enter lots of competitions. Can we do that at James Hargest?***
Yes. Students can challenge themselves by entering competitions including ICAS (International Competitions and Assessments for Schools) Oral Communication Assessment, Kids Literature Quiz, Young Writers Competition, SMAC Maths, NIE Southland Times Current Events Quiz, Science Badges, Language Olympics and the Otago University Problem Solving Competition.
- ***Are there any other trips?***
We have ski trips to the Remarkables Ski Field.
- ***What do you do for really bright students?***
We run a Year 7 and 8 GATE programme that focuses on thinking and inquiry skills. In Maths we provide students with extension classes to further challenge them. Talented athletes can extend their skills by joining our Sports Academy.
- ***Where do classes go for camps?***
In Term One, Year 7 students have a three day camp at Omaui and Year 8 students have a four day camp at Deep Cove.
- ***What cultural opportunities are there at the Junior Campus?***
We have a choir and also have a school production each year. Our Kapa Haka rōpū performs at Polyfest and Ngā Pūtangitangi. The Junior Campus students also perform at ShowQuest. Students can join the assembly band, ukulele group and jazz concert bands.
- ***Do the students from both campuses mix at any time?***
There are opportunities for cross campus interaction which can include productions, cultural group, school band, sport and mentoring. Year 8 students make several visits to the Senior Campus in preparation for their move to Year 9.
- ***Do I have to buy a digital device?***
It is highly recommended students have their own device. "Equity devices" are available daily from the library.

Year 9 and 10 Programmes

Essential Subjects

- **English:** Developing effective communicators
- **Mathematics:** Learning you can count on
- **Science:** Interactions and understandings of the world around us
- **Social Studies:** Knowledge of the world and its societies
- **Health and Physical Education:** Co-operative learning through movement

Option Subjects

- **Digital Technologies:** Understanding software packages for today's technological society
- **Music:** Performance alongside theoretical and historical contexts
- **Visual Art:** Making and understanding art works
- **Fashion and Design:** Creating fashion solutions within the design process
- **Food and Nutrition:** Understanding the science of food and nutrition. Learning practical skills in the culinary arts
- **Hard Materials Design:** Solutions to technological issues through design and problem solving
- **Agriculture and Horticulture:** Get growing for life skills or a career

- **Design and Visual Communication:** Communicating design ideas through practical solutions
- **Drama:** Working collaboratively to increase confidence through cooperation and commitment
- **French:** Learning the French language through fun and food
- **Japanese:** Interacting in the Japanese language and culture
- **Māori:** Our national language, history and culture
- **Spanish:** Communicating with the Spanish language and people



Care and support Years 9 - 13

Form Teachers

Form Teachers take a personal interest in the progress and achievement of their students. Students meet with their Form Teachers twice a week and most will have the same Form Teacher while at the Senior Campus. Form Teachers have a pastoral, mentoring role and do not teach their Form Class.

Deans

Students are supported by a House Dean. House Deans oversee the welfare and progress of their students and provide academic and pastoral support for students in their care. The teacher of Te Reo Māori also works in a pastoral care capacity with Māori students.

House Leaders

House Leaders work with House Captains to organise House events. These events are designed to be inclusive and cater to a range of talents and abilities. House Leaders support the pastoral sense of belonging for students in their Houses.

Guidance Team

The Guidance Team work with students and their families to provide a sound support base so that any problems can be identified and addressed. They provide a professional, specialist and confidential service which helps students discover their own strengths and take responsibility for themselves. The key to managing stress or difficulties is having a strong support team.

Careers

Our Careers team work to provide students of all ages with advice on appropriate course structures and career choices.

Peer Support

Peer support is designed to make the transition to the Senior Campus easier by giving small groups of Year 9 students a Year 13 “buddy”. Students follow a programme of orientation and initiation activities, and are able to discuss school related issues and build a relationship with their “buddy”.



Information

Enrolments

The electronic enrolment form is available on our website: www.jameshargest.school.nz. If you require a paper form, please contact office@jameshargest.school.nz

Office Contact

Telephone: 03 2176129

Office hours: **Junior Campus** 8.00am-4.30pm
Senior Campus 8.00am-4.00pm
8.00am-3:30pm on Fridays

Junior Campus Email: juniorcampus@jameshargest.school.nz

Senior Campus Email: office@jameshargest.school.nz

Attendance

Students should ensure they are at school after 8:20am and before 8.45am and leave by 3.30pm. Outside these times students should be under direct supervision of a teacher e.g. working in the Library or sports practice.

By 9.00am staff have electronically marked attendance. By 10:00am if your child is not at school and we have not heard from you, you will receive a text message to let you know your child is not in class. It will be sent to the cellphones of both caregivers if we have two contact numbers.

Please try to let us know of any absences by contacting our Attendance Officer before those link calls are made.

Absences - Senior Campus

If your child is absent contact us by 9.15am on the day of the absence with your child's name, a reason for absence, name of person calling. This facility is available at any time day or night so you need not wait until office hours to communicate. Students arriving late must sign in at Student Administration when they arrive.

- Phone 2176129 extn 205
- Email lmartin@jameshargest.school.nz
- or via School App/Absentee



Absences - Junior Campus

If your child is absent from school, including being late, please telephone the school office before 9.00am on **2176129 Ext. 895**. The class roll is taken at 8.55am and absences are reported to the office at that time. If your child arrives late, they are to go to the office to sign in before they go to their class. If you are aware in advance that your child is going to be absent, please advise the school office. As we do try to contact parents/caregivers regarding all unexplained absences, it is a great help to our office staff if absences are reported.

- Phone 2176129 (extn. 895)
- Email gfindlay@jameshargest.school.nz or mcribb@jameshargest.school.nz
- or via School App/Absentee

Leave

All requests for special leave should be directed to the Associate or Deputy Principal in writing. Please arrange family holidays during the school holidays. Student progress may be severely hindered if leave is required during term time. Such requests for leave are

expected to be the exception rather than the norm. Teachers are not expected to provide work for students in the case of leave being granted. Assessments missed will be rescheduled if possible but this will not always be the case and students may miss opportunities to gain credits in NCEA.

Appointments

When a student needs to leave school they must sign out and in at Student Administration. Verification in the form of a note or a phone call is required from parents/caregivers (please be specific about type of appointment). Medical, dental and other appointments should be made outside school hours whenever possible.

On-Site Physiotherapist

An on-site physiotherapist is available based at the Senior Campus and comes twice a week. Bookings can be made by phoning **2176129 (Ext 205)**.





Medication

Parents should inform the school about any medication their child is taking. Medication should be stored at the sick bay and students should not be carrying it around the school.

Accidents

In cases where there is any doubt about the extent of an injury, students are referred to the Emergency Department at Southland Hospital. Parents will be contacted as soon as possible.

Bus Transport

Queries about school bus transport should be directed to Mr Pannett (Senior Campus). Details of bus routes can be sourced from GoBus (Phone 2182419).

Concerns

Issues should be addressed in the first instance to the teacher concerned, or Form Teacher. For more serious issues contact the Year Level Dean (Year 7 and 8) or House Dean (Senior Campus).

Lunchtimes

Students must remain on the school grounds at lunchtime unless they are going to their own homes. Students are not permitted to have other students at their home during the lunch break. The Salford Street shopping area is not to be visited during school hours. This includes lunchtimes and intervals. The only exceptions are Year 13 students.

Lunch Areas

Year 11 and 12 students may lunch in the Cafeteria. Year 9 and 10 students may, on cold or wet days, lunch in the hall. When the hall is unavailable the gallery in the Hargest Centre may be used instead. Students may not lunch in classrooms/corridors. When lunching outside students are to use the facilities provided in the main quad. At the Junior Campus, lunch is in homerooms for the first 10 minutes of lunchtime.

Out of Bounds Areas

- Trees on the sides of the fields
- All fence Lines
- The Staff car park and Main Entrance
- Street frontages
- Garden areas

Bicycles and Scooters

Stands are provided. Bicycles and scooters are not to be ridden in the school grounds. Bicycle helmets are compulsory. All bicycles should be locked and are left at the owner's risk. Scooter stands are provided and a padlock is required to keep these secure.

Motor Vehicles

Students must register motor vehicles with the school. Students are not to park on the school grounds. We reserve the right to restrict the use of student motor vehicles if responsible driving standards are not met, and to make complaints to the Police if we believe student safety has been compromised.

Damage

Damage to school property must be reported immediately to the one of the Deputy Principals. Students who damage, deface or lose school property are liable for the cost of replacement/repair.

Vandalism

JHC will seek to recover costs for any deliberate damage or destruction of property.

Behaviour

Our Core Values reflect the positive ideals that we expect students' behaviour to be based on.



Cell Phones

- **Junior Campus** Cell phones are to be **handed in to the homeroom teacher at 8:50am** for safe storage. They are returned to students at the end of the day.
- **Senior Campus, Year 9, 10, 11 & 12:** Cell phones are to be **handed in to the classroom teacher each period** for safe storage. They are returned to students at the end of the period.
- **Senior Campus, Year 13:** Cell phones must be **switched off and in your bag or pocket during class, assembly, etc,** unless specifically instructed by a teacher to “have them out” and used for educational purposes. If they are used inappropriately they will be confiscated.
- Students are permitted to use the school phone in emergencies.
- Cell phones are not to be used in the Student Administration area, the Guidance area or Sick Bay.
- Cell phones used without teacher permission will be confiscated. Year 9-12 students' parents will be asked to collect these at the end of the school day.

School App

The James Hargest College app can be downloaded free from the respective app stores. It provides a vast array of information and is an effective way to report absences and receive alerts. Download **School Apps** NZ and select James Hargest College.

Stationery Shop (Senior Campus)

All school stationery requirements are available through Student Administration at intervals and lunchtimes. These are very competitively priced. Other services offered include binding and laminating. Students are expected to have stationery at the start of the school year. Lists are on the Hargest web site.

VPN Use

VPNs are not permitted on devices connected to the school network. Access to school WiFi will be withdrawn if they are found on student devices.

Cafeterias

The cafeterias are open at intervals and lunchtimes. Full lists of food available and prices are well advertised. EFTPOS facilities, including payWave, are available. Junior Campus students order their lunch before school or at interval.



Naming Property

We strongly advise naming of all items of uniform and property. Students may check lost property: Years 7 and 8: Office, Years 9 - 13: Student Administration.

Newsletters

These are published on a Friday early each month during term time). These are available on the school app and on-line on the Hargest web site. The link is also emailed to parents/caregivers.

EFTPOS/payWave

This is available at both offices to pay accounts and at the Canteen. Cash is not given out.

School Donation

\$55 per annum per student. This fee, fixed by the Board of Trustees, is used to meet the demands which cannot be met from operational grants.



PTA Donation

\$15 per annum per student provides for essential items of equipment not funded by the government. The Parent Teacher Association determines which projects this donation is used to support.

School Accounts

School accounts are e-mailed every term. Payment can be made to the school office by EFTPOS or direct credit -
Account number 020924-0408612-02 - Senior Campus
Account number 02-0924-0408612-01 - Junior Campus
Difficulties with payment should be directed to the school office.

Some practical subjects have costs for materials used as outlined in the **Subject Outline** guide.

Trips, camp, sports teams and recreation costs are paid for on a user pays basis. Parents will be notified well in advance when payment is due. Junior Campus has a Transport Activities cost to cover bus, excursions and activities throughout the year.





Sustained Silent Reading (SSR) and Drop Everything and Read (DEAR)

We all do this every day for 15 minutes after lunch (except on Sport and Rec days). All students are expected to have reading books (not magazines) in their possession, every day! Libraries are open at intervals and lunchtimes for students to get books.

Reporting to Parents

Reports will be emailed at the end of Term Two and towards the end of the year.
Parent/Teacher Interviews (Senior Campus) and Student Centred Conferences (Junior Campus) are held twice a year.

Other Information Evenings

Years 7, 8 and 9 Meet the Teacher evenings are held early in Term One.
Careers and course information evenings are held for parents and students in Years 10 - 12 in Term Four.



*Brigadier
James Hargest*

School Regulations

Essential rules are outlined on the Hargest Website. The Board of Trustees and Principal reserve the right to make and enforce such regulations as necessary for the satisfactory running of the school. Parents, by enrolling their son/daughter, agree to these regulations.

Use of Student Photos

At James Hargest College we celebrate student success in a number of forums often involving photos of our students. These images are likely to become part of our public documents eg newsletters, website and promotional materials. The specific purpose for photos will normally be indicated at the time they are taken.



Summer

Dress

Y 9-13

Winter

Vest
Y7-13

Y 7-13

Y 7+8

Y 7-10

PE

Uniform

Girls' Uniform

- **Skirt:** Hargest green A-line skirt.
- **Kilt:** Hargest kilt to be worn with mid brown tights or above the knee beaver brown socks and the long sleeved white shirt (skirt or kilt may be worn throughout the year, kilt not worn with polo shirt)
- **Shirt:** White blouse with long sleeves, pointed collar and straight hem.
- **Polo:** White short sleeved polo shirt with Hargest collar stripes and pocket monogram. May be worn with grey skirt or shorts.
- **Socks:** $\frac{3}{4}$ white below the knee socks or white sockettes.
- **Shoes:** Plain black leather, laced, flat, dress (NOT t-bar).
- **Jersey:** Cardinal red V necked jersey with school monogram.
- **Vest:** Cardinal red V necked vest with school monogram.
- **Blazer:** School regulation blazer may be worn.
- **Tie:** Red, gold, grey; must be worn with long-sleeved blouse with summer and winter uniform (Senior Campus only).
- **Trousers and Shorts:** Regulation grey. (Trousers not with polo shirt)
- **Jacket:** JHC Black Jacket with school monogram (may be worn in class).



Boys' Uniform

- **Trousers and Shorts:** Regulation grey. (Long trousers are worn with white shirt and tie at the Senior Campus) Junior Campus - with grey flannel shirt only (ties are not worn at the Junior Campus)
- **Shirt:** Long sleeved, straight hem grey flannel. White sleeve shaped hem with tie only, with the trousers.
- **Polo:** White short sleeved polo shirt with Hargest collar stripes and pocket monogram. Worn only with shorts.
- **Socks:** Grey with regulation red and gold top.
- **Shoes:** Plain black leather, laced, dress.
- **Jersey:** Cardinal red V necked jersey with school monogram.
- **Vest:** Cardinal red V necked vest with school monogram.
- **Blazer:** School regulation blazer may be worn
- **Tie:** Red, gold, grey; must be worn with long-sleeved white shirt (Senior Campus only)
- Belts: Black or dark grey with standard buckle (Senior Campus only).
- **Jacket:** JHC Black Jacket with school monogram (may be worn in class).



Boys' Dress Uniform

- Long grey trousers, a white shirt and plain grey or black socks. School tie must be worn. Plain black leather, flat, dress shoes.

Uniform for Travelling Teams

- Dress uniform with blazer

PE Uniform – Girls' and Boys'

- Plain black shorts or black track pants.
- Sports top T-shirt, red and gold. White polyprop may be worn underneath in winter. Gym shoes with white soles (no skate shoes, soft soles without laces or soft sandals). White or black short socks.
- Optional - black warm-up hoodie with school logo on front and surname on back, worn with PE uniform only.
- PE uniform may be worn to and from school on Fridays (Junior Campus only).



General

- **Sandals:** Optional in terms 1 and 4. Flat black, plain, with a heel strap and one ankle strap. Thong styles are not permitted. Socks are not to be worn with sandals. Sandals are not to be worn in laboratories and technology rooms. Sandals are not to be worn in Terms 2 and 3.
- **Jacket:** Any plain black weatherproof jacket (not cotton). **The JHC black jacket with monogram is available online at <https://kooga.co.nz/james-hargest-college/>**
- **Undergarment:** A plain white or black t-shirt or polyprop may be worn under the uniform tops for extra warmth.
- **Hat:** Plain white hat or school monogrammed bucket hat for sun protection.
- **Beanie:** Optional. Cardinal red with gold stripe.
- **Scarf:** Optional. Cardinal red with gold stripe.
- **Gloves:** Optional. Black.
- **Blazer:** Regulation red with monogrammed pocket.

Personal Grooming

- Hair colour must be natural in appearance. Unnatural and or multi-coloured hair is unacceptable
- Extreme hairstyles are not acceptable (including shaved head, partially shaved head, mohawks and tails)
- Hair must be tidy and off the face
- Students with longer hair (that falls beneath the collar) must have it all tied back with plain hair bands (only colours of the school uniform may be used)
- Boys' faces must be clean shaven
- No jewellery is to be worn. The exception is one plain gold or silver stud or small sleeper in each earlobe
- No make-up or nail varnish may be worn

General Points

- All uniform items are to be worn correctly
- All students using the workshops must wear protective clothing
- Skirts must be of a reasonable length, neither very short nor very long
- Parents are asked to be sure that uniform and footwear are in good order at the start of each term. All garments should be clearly marked with the owner's name
- If in doubt regarding items of uniform, please check by ringing the school office before a purchase is made

The PTA operates a scheme for the sale of second-hand uniforms. Sales are held at the end of the school year and towards the end of January. The sales will be advertised and are in the school newsletter. At other times, items can be bought or sold by arrangement with Angela in Student Administration. If, for any reason, a student has to wear an item of non-regulation clothing to school, they must bring a note from parent/caregiver explaining the reason and bring this to the Associate Principal or a Deputy Principal. Uniform items may be loaned in the short term.



Learning beyond the classroom

Instrumental music

Itinerant Music Tuition, Chamber Music Contest, String Ensemble, Hargest Music Festival, Concert Band, Smokefree Rock Quest, Jazz Fest, Jazz Groups

Speaking

Inter-school Debating, School Public Speaking Competitions, Shakespeare Reading Competition, Rotary and Lions Competitions

Drama

Year 7 and 8 Production, Year 9 and 10 Production, Major Production, Sheilah Winn Shakespeare Competition, ShowQuest, Year 9 and 10 Play

Writing

School Magazine, Inter-school Writing Competitions, Writing Club and Interrobang

Design and Art

Smokefree Young Designers' Award, Hokonui Fashion Awards, Southland HETTANZ Fashion, Design and Craft Awards, Southland Secondary Schools' Art Competition





MUNA

Model United Nations Assembly

Food and Technology

Southland Schools' Cookery Competition

Choral music

School Choir, Ancora Choir, NZ Choral Festival Competition, School Music Festival

Te Reo Māori

Kapa Haka, Manu Korero Competition, Polyfest, Hautonga, Nga Putangitangi

International links

Student exchange schemes, e.g. Rotary, AFS, Your Education STS (when available)

Duke Of Edinburgh Award Scheme

Sports Exchange

Inter-school Sports Exchanges
Oamaru Intermediate, Wakatipu High School, Taieri College

Book Club

Library Book Club

Sound and Lighting Team

Sound and Lighting/Technical support for Assemblies and Production work

Outdoor pursuits

Ski trips, snow boarding

International trips

Students have had opportunities for international travel to Italy, Spain, Japan, France, Greece, Thailand, Vietnam, India and New York (currently on hold)

Service Clubs

LEO Club (Young Lions)
International Friendship Club
World Vision Leadership

ESOL

English for speakers of other languages

GATE (Year 7 and 8)

Gifted and Talented Education supporting
and extending students with special
abilities and talents

Outdoor Education

Personal growth in an outdoor
environment

Peer Support

Students supporting students

Literacy tuition

Individual and small group support.

Chess

After school and lunchtime chess club

Sports

Students may elect to be involved in a
vast range of sporting codes. These are
advertised in the daily notices.

Coding

After school coding and robotics group





Library information

We have everything you need from research resources to a good read.

Hours of Opening

Senior Campus 8.30am-4.30pm (5.00pm for Study Centre)

Junior Campus 8.30 – 4.00pm

Library Activities - Senior Campus

A different activity happens every lunchtime in the Reading Room. We have a book club including a dedicated manga group, a relaxation session, a knitting group, a chess club, as well as a robotics and lego session. Students are welcome to join in at anytime or come in to talk to Miss Adam in the library for more information.

Library Activities - Junior Campus

The Junior Campus has games and chess boards available at lunchtime every day.

Library Code of Conduct

Remember to bring your student ID card or Library barcode with you to the Library if you want to borrow resources.

Before you enter the Library, all bags must be placed on the bag racks. Please do not bring food or drink into the Library. Please respect the other users of the Library.



Borrowing Devices

Students who do not have their own device are able to borrow one from the library for the day. The device is issued with the understanding that if any damage occurs to the device under your care, you will be held responsible and charged for repair or replacement. The age and depreciation value of the device will be taken into account.



Care and support - Years 7 - 13

	Junior Campus	Senior Campus
Form/ Homeroom Teachers	Students spend the majority of their day with their homeroom teacher. The homeroom teacher gets to know the “whole” student and provides support, advice and guidance for them. Homeroom teachers liaise with home, keeping parents updated with pastoral and academic information.	Form teachers take a personal interest in the progress and achievement of their students. Students meet with their Form Teachers at Form Time twice a week. Form Teachers stay with their form class throughout their time at the Senior Campus.
Deans	There is one Dean for each year level. Deans are responsible for the welfare of students in their year level. They provide pastoral support and guidance for students.	House Deans are responsible for students in their House whanau. They oversee the welfare and progress of their students and provide academic and pastoral support for students in their care.
Guidance Team	The Guidance Team work across both campuses. They work with students and their families/caregivers/whānau to provide a sound support base so that any problems can be identified and addressed. They provide a professional, specialist and confidential service which helps students discover their own strengths and take responsibility for themselves. The key to managing stress or difficulties is having a strong support team.	
Careers	The Careers Team work to provide students of all ages with advice on appropriate course structures and career choices.	

Junior Campus

Senior Campus

Peer Support including Peer Mentoring and Peer Tutoring

Peer Support is designed to help the transition to the Senior Campus. Year 8's are introduced to the Year 12 Peer Support Leaders in Terms 3 and 4 of their last year at Junior Campus. The Year 12 Peer Support Leaders follow the Year 8 group through to Year 9 and support them in formtime. The Peer Support leaders are trained in active listening, mediation and self-care.

Homework

Homework helps students learn to manage their work load and complete set tasks. Homework is set regularly and attention to it is actively encouraged. Google calendar is used at Hargest to help develop good homework habits.



Science
21

Junior Campus map

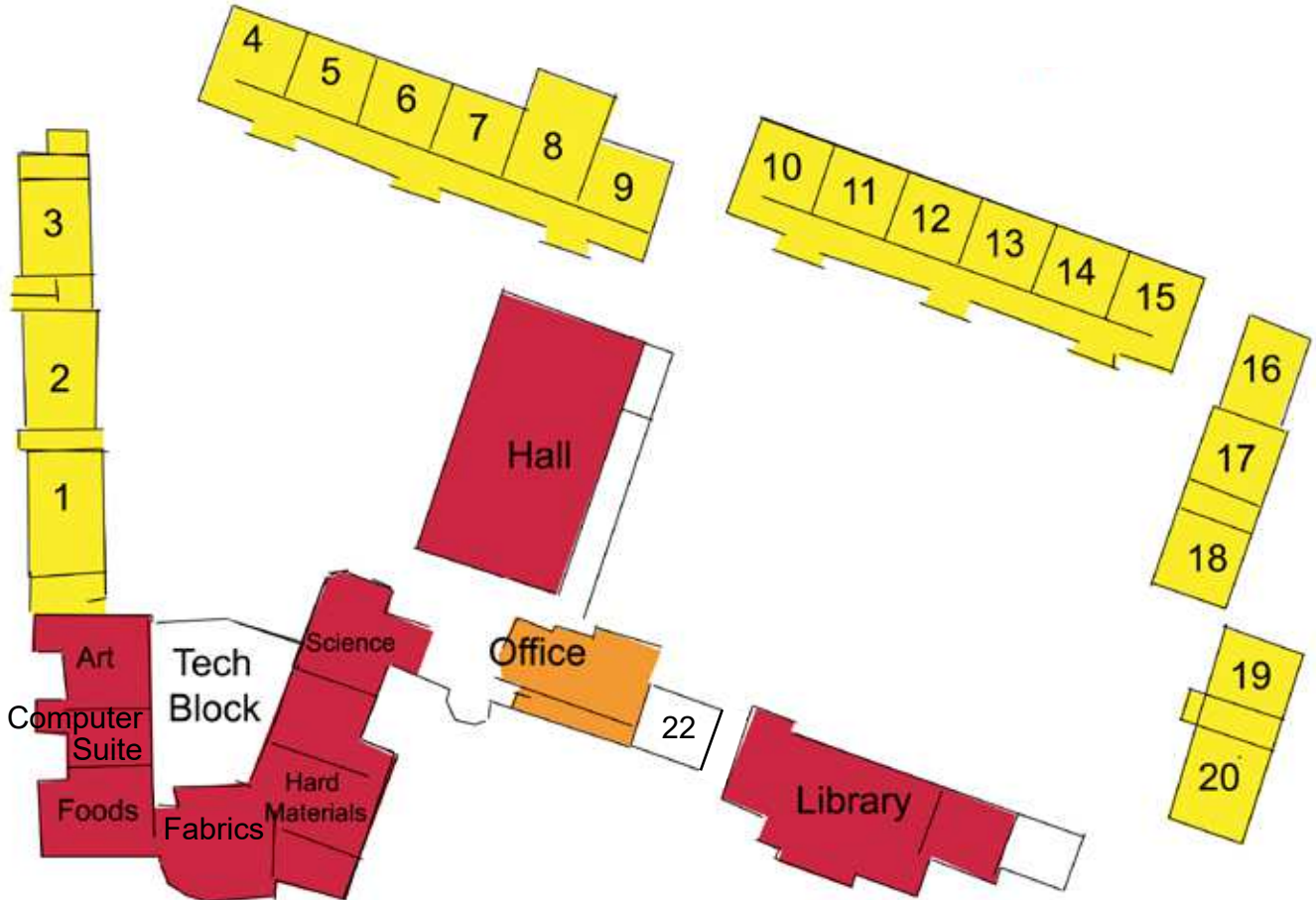

Senior Campus map

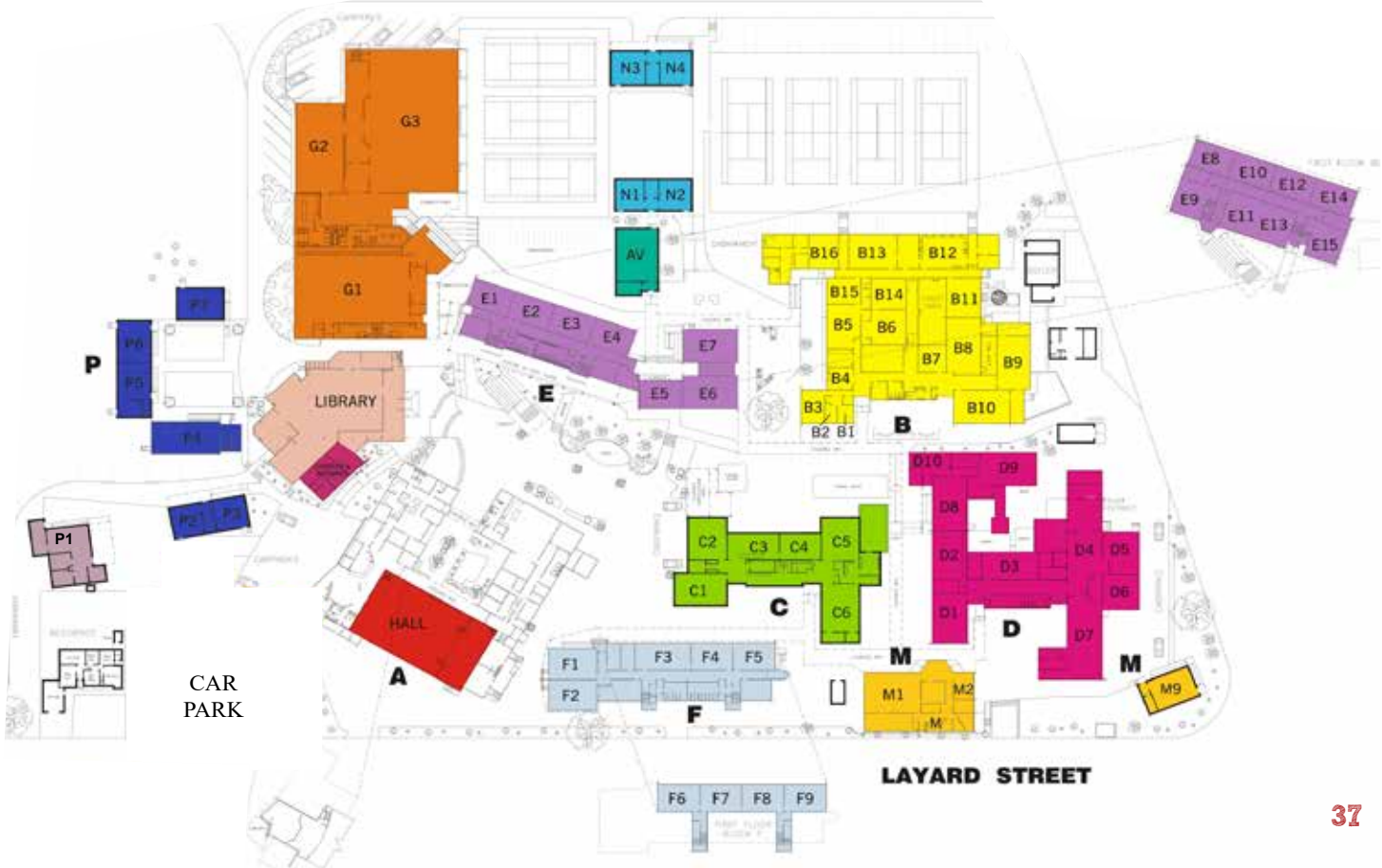

Learning pathways

All subjects in **yellow** are compulsory

This is a guide only. See our annual subject booklets for senior subject pre-requisites. (Note: courses may be combined or not run if there are insufficient numbers).

Year 7 & 8	Year 9 & 10	NCEA Level 1	NCEA Level 2	NCEA Level 3
Art	Art	Art	Art Design Art Painting Art Photography Art Printmaking	Art Design Art Painting Art Photography Art Printmaking
Digital Technologies	Digital Technologies	Accounting Digital Technologies Media Digital Technologies Programming Economics	Accounting Digital Technologies Media Digital Technologies Programming Economics Business Studies	Accounting Digital Technologies Media Digital Technologies Programming Economics
Drama	Drama	Drama	Drama	Drama
	Design & Visual Communication	Design & Visual Communication	Design & Visual Communication	Design & Visual Communication
English	English	English A English B Media Studies	English A English B English Literacy Media Studies	English A English B English Literacy Media Studies
ESOL	ESOL	ESOL	ESOL	ESOL
Food Technology Fabric Technology	Fashion & Design Food & Nutrition	Fashion & Design Food & Nutrition Culinary Arts	Fashion & Design Food & Nutrition Culinary Arts Childcare & Development	Fashion & Design Food & Nutrition Culinary Arts
French Japanese Māori Spanish <i>(all short courses)</i>	French Japanese Māori Spanish	French Japanese Māori Spanish	French Japanese Māori Spanish	French Japanese Māori Spanish

Year 7 & 8	Year 9 & 10	NCEA Level 1	NCEA Level 2	NCEA Level 3
<i>Mathematics</i>	<i>Mathematics</i>	<i>Mathematics T</i> <i>Mathematics G</i> <i>Mathematics B</i> <i>Mathematics N</i>	Mathematics A Mathematics B Mathematics and Finance Mathematics G	Mathematics with Calculus Mathematics with Statistics A Mathematics with Statistics B
<i>Music</i>	Music	Music	Music	Music
<i>Health & Physical Education</i>	<i>Health & Physical Education</i>	Health & Physical Education	Physical Education Health Education Outdoor Recreation	Physical Education
<i>Science</i>	<i>Science</i> Agriculture & Horticulture	<i>Science (Callaghan)</i> <i>Internal</i> <i>Science (MacDiarmid)</i> <i>Science (Wiffen)</i> Primary Industries	Science Biology Chemistry Physics Primary Industries	Science Biology Chemistry Physics Agriculture & Horticulture
<i>Social Studies</i>	<i>Social Studies</i>	Geography History	Classical Studies Geography History Tourism	Classical Studies Geography History Tourism
<i>Hard Materials Design</i>	Hard Materials Design	Hard Materials Design Hard Materials Trade	Mechanical Engineering Woodwork & Furniture Making Building & Construction Hard Materials Design	Hard Materials Design Hard Materials Trade
			Transition Skills Gateway	Gateway
			Star Courses	

Senior Campus

288 Layard Street, Invercargill, New Zealand

Email office@jameshargest.school.nz

Junior Campus

6 Layard Street, Invercargill, New Zealand

Email juniorcampus@jameshargest.school.nz

Phone +64 3 217 6129

www.jameshargest.school.nz

